

LOGIK

19" / 22" LED Backlit LCD TV

Instruction Manual

L19LDIB10

L22LDIB10



ENERGY SAVING
LED
BACKLIT

HD
ready

digital 

Freeview

HDMI™
HIGH DEFINITION MULTIMEDIA INTERFACE



Contents

Preparation	4
Unpacking the TV	4
Installing / Removing the Base Stand	5
Front / Top View and Controls.....	6
Side View and Sockets	7
Installing Batteries in the Remote Control	8
Remote Control Operation Range.....	8
Remote Control	9
Connections	11
Making Video and Audio Connections.....	11
Connecting an A/V Device with HDMI Cable.....	11
Connecting a High-Definition (HD) Device with YUV SCART Adaptor	12
Connecting an A/V Device with SCART Cable	12
Connecting an A/V Device with Composite Cable	13
Connecting Earphones.....	13
Connecting the Aerial	13
Initial Setup	14
Turning the TV On for the First Time	14
– Selecting the Input Source.....	15
– Channel Selection	15
– Volume Adjustment.....	15
Using the Features	16
Customising the TV Setting (TV, DTV or Radio Mode Only).....	16
– Auto Tuning	16
– DTV Manual Tuning.....	16
– ATV Manual Tuning	17
– Channel Edit	18
– CI (Common Interface) (DTV Mode).....	19
Customising the PICTURE Setting	20
Customising the SOUND Setting	21
– Audio Language for DTV	21
Customising the TIME Setting.....	22
Customising the SETUP Setting.....	23
– Video Size (Aspect Ratio)	23
Customising the LOCK Setting.....	24
– Lock System	24
– Change Password	24
– Block Channel	25
– Parental Guidance	25
Teletext (TV Mode).....	26
– To Turn on Teletext Function.....	26
Digital Teletext (DTV Mode).....	27
– Teletext within Digital Service.....	27
EPG (Electronic Programme Guide) (DTV Mode)	27
– Switch On/Off EPG.....	27
– Select a Programme	28
Maintenance	29
Hints and Tips	29
Display Modes	31
YPbPr Mode	31
HDMI Mode	31
Specification	31
Safety Warnings	32

Congratulations

on the purchase of your new Logik TV.

Your new TV has many features and incorporates the latest technology to enhance your viewing experience. We recommend that you spend some time reading this instruction manual in order that you fully understand these features. You will also find some hints and tips to help you resolve any issues.

Read all the safety instructions carefully before use and keep this instruction manual for future reference.

Unpacking the TV

Remove all packaging from the TV. Retain the packaging. If you dispose of it please do so according to local regulations.

The following items are included:

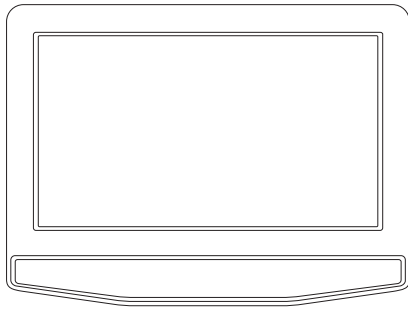

TV

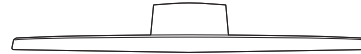

TV Base
(For L19LDIB10: P.N.: 509-818125W001
For L22LDIB10: P.N.: 509-812125W001)

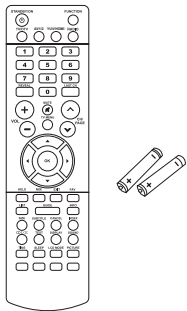

Remote Control / AAA Batteries x 2
(P.N.: 043-A55652W090)

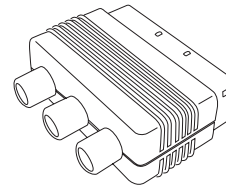

YUV SCART adaptor
(P.N.: 138-RGB040W001)

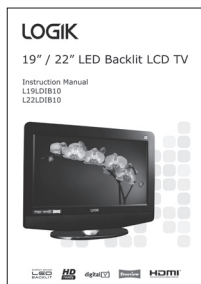

Instruction Manual
(P.N.: 811-86J191W010)

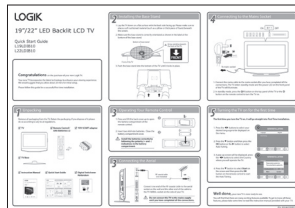

Quick Start Guide
(P.N.: 810-86J195W010)

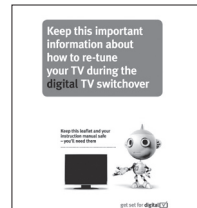

Digital TV Switchover Addendum
(P.N.: 810-000005W740)



If items are missing, or damaged please contact Partmaster (UK only). Tel: 0870 6001 338 for assistance.

Installing / Removing the Base Stand



The LCD display is very fragile, and must be protected at all times when installing and removing the base stand. Be sure that no hard or sharp object, or anything that could scratch or damage the LCD display, comes into contact with it. DO NOT exert pressure on the front of the TV at any time because the screen could crack.

1. Disconnect all cables connected to the TV.
2. Lay the TV down on a flat surface with the back side facing up. Please make sure to place a soft cushioned material (such as a pillow or thick piece of foam) beneath the screen.
3. To install the base stand, make sure the base stand is correctly orientated as shown in the label at the bottom of the base stand.

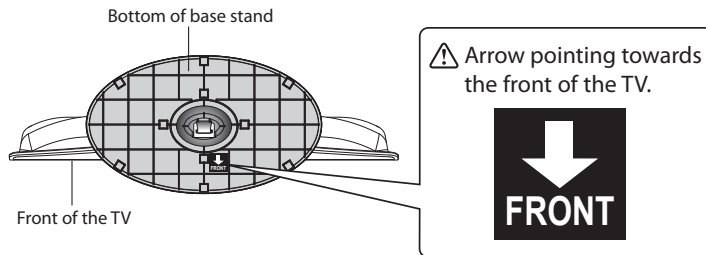

4. Push the base stand into the bottom of the TV until it locks in place.



Remove the base stand before mounting the TV onto the wall.

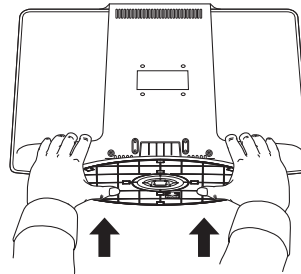

5. To remove the base stand, use your finger to carefully push up on the latch and pull the base stand out.

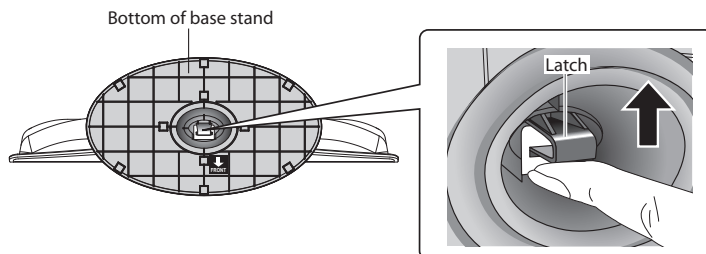

6. Mounting on the wall. This TV is designed to be wall-mounted with a standard 75 mm x 75 mm mounting kit designed for flat-panel TVs (sold separately). Mount this TV according to the instructions included in the mounting kit. Due to the space restriction, we recommend you to make all connection (refer to page 32 for details) before final mounting on the wall.

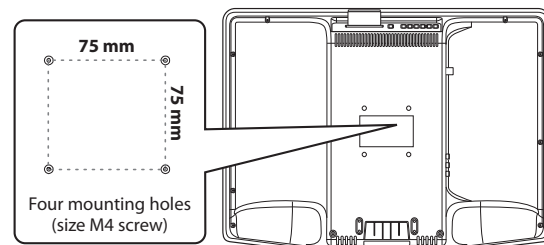

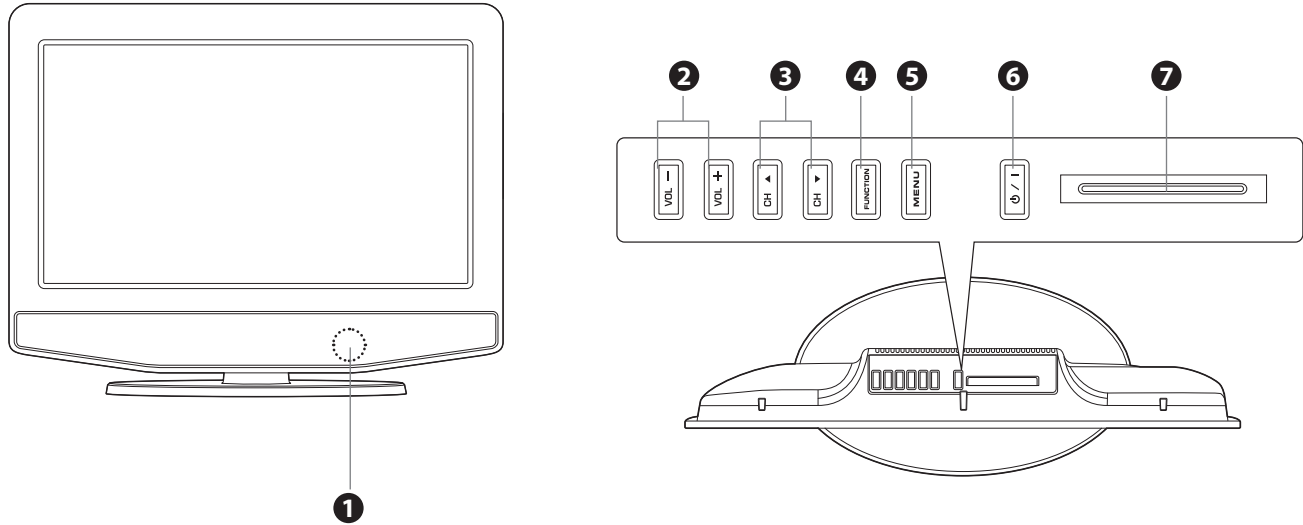

Front / Top View and Controls

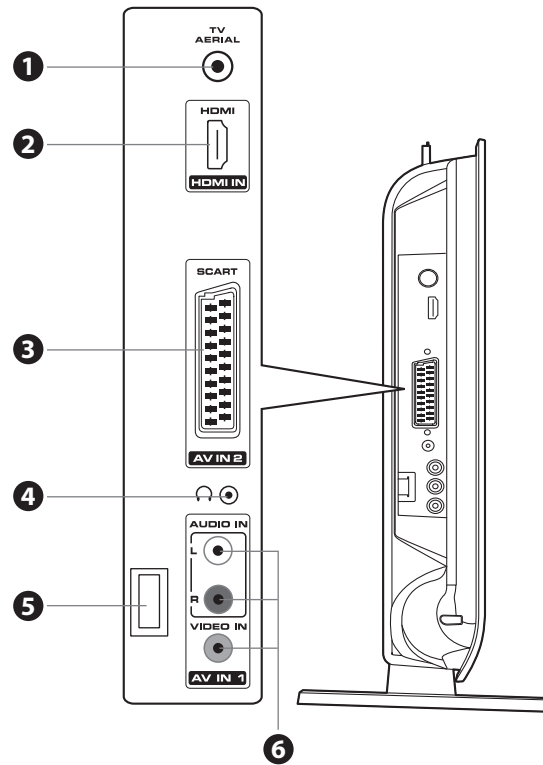

Item	Description
1 POWER LED	Illuminates when the TV is in standby and goes off when the TV is turned on.
IR (Infrared Receiver)	Receives IR signals from the remote control. Do not put anything near the sensor, as its function may be affected.
2 VOL +/-	Adjust the volume.
3 CH ▲▼	Select a channel. Select sub-menu of OSD menu.
4 FUNCTION	Select among the different input signal sources: DTV, TV, AV1, AV2/SCART, YUV/SCART or HDMI
5 MENU	Displays the OSD (on screen display) menu.
7 ⏻/⏿	Switch the TV on from standby. Switch the TV back to standby.
8 CI (Common Interface) Slot	Allows the insertion of a Common Access Module. (Refer to page 19 for details)

Side View and Sockets



Item	Description
1 TV AERIAL	Connect to the aerial socket on the wall with the RF coaxial cable.
2 HDMI IN	HDMI (High-Definition Multimedia Interface) provides an uncompressed, all digital audio/video interface between this TV and any HDMI-device, such as a set-top box, blu-ray player, and A/V receiver.
3 SCART Input	Connect to VCR, DVD Player, or other AV devices with SCART output sockets.
4 	Connect earphones for private listening.
5 MAINS CABLE	Connecting to the mains socket.
6 VIDEO / AUDIO (L/R)	Connect to the Composite VIDEO and AUDIO (L/R) output sockets on external video devices.

Installing Batteries in the Remote Control

1. Press and lift the back cover up to open the battery compartment of the remote control.
2. Insert two AAA size batteries. Make sure to match the (+) and (-) ends of the batteries with the (+) and (-) ends indicated in the battery compartment.

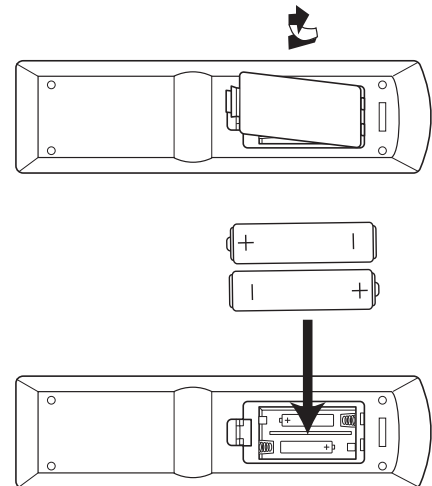

3. Close the battery compartment cover.



Handling the Batteries

- Improper or incorrect use of batteries may cause corrosion or battery leakage, which could cause fire, personal injury or damage to property.
- Only use the battery type indicated in this manual.
- When the batteries are exhausted, the remote will not function. Replace both batteries at the same time with new ones.
- Do not install new batteries with used ones and do not mix different types of batteries.
- Do not dispose of used batteries as domestic waste. Dispose of them in accordance with local regulations.



Handling the Remote Control

- Take care of your fingernails when you press and hold the battery release tab.
- Do not drop or cause impact to the remote control.
- Do not spill water or any liquid on the remote control.
- Do not place the remote control on a wet object.
- Do not place the remote control under direct sunlight or near sources of excessive heat.
- Remove the battery from the remote control when not in use for a long period of time, as it could cause corrosion or battery leakage and may result in physical injury and/or property damage including fire.

Remote Control Operation Range

Point the remote control at the TV no more than 5 metres from the remote control sensor on the TV and within 60° in front of the TV. The operating distance may vary depending on the brightness of the room.

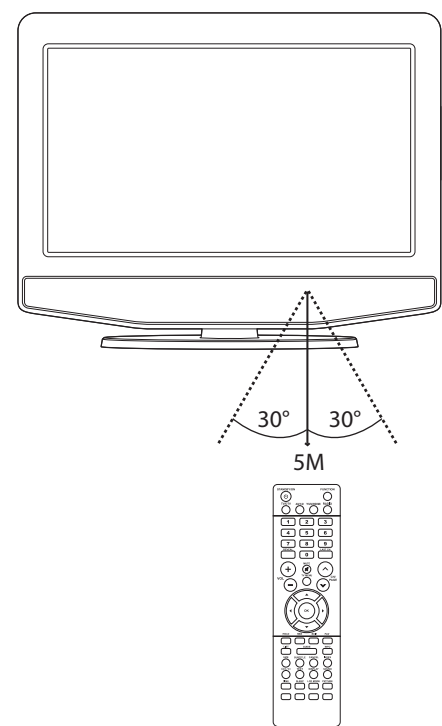

Remote Control

- 1** **STANDBY/ON**
Switch the TV between on and standby mode.
- 2** **FUNCTION**
Select among the different input sources: DTV, TV, AV1, AV2/SCART, YUV/SCART or HDMI.
- 3** **TV/DTV**
A short-cut to switch the input source between TV and DTV.
- 4** **AV1/2**
A short-cut to switch the input source between AV1, AV2/SCART.
- 5** **YUV/HDMI**
A short-cut to switch the input source between YUV/SCART or HDMI.
- 6** **RADIO**
A short-cut to switch to digital radio channels directly. (DTV mode)
- 7** **0-9 Number Button**
Select a programme.
Select numbered items in a menu.
- 8** **REVEAL**
Reveal hidden information such as the answer to a quiz in Teletext. (TV mode)
- 9** **LAST CH**
Return to previously viewed channel.
- 10** **MUTE**
Mute and restore your TV sound.
- 11** **VOL. +/-**
Adjust the volume.
- 12** **TV MENU**
Display the OSD (on screen display) menu.
- 13** **CH/PAGE** /
Select a channel.
Press to go to the next or previous Teletext page. (TV mode)
Press to go to the next or previous page on the Channel Edit & Favourite screens. (TV / DTV mode)
- 14**
Allows you to navigate the OSD menus and adjust the system settings to your preference.
OK
Confirm the selection in the OSD menus.
- 15** **HOLD**
Freeze a multi-page passage on screen in Teletext. (TV mode)
MIX
Select Teletext with a TV programme.
EXIT
Press to exit the menu and return directly to normal viewing.
FAV
Display the Favourite Channel List.

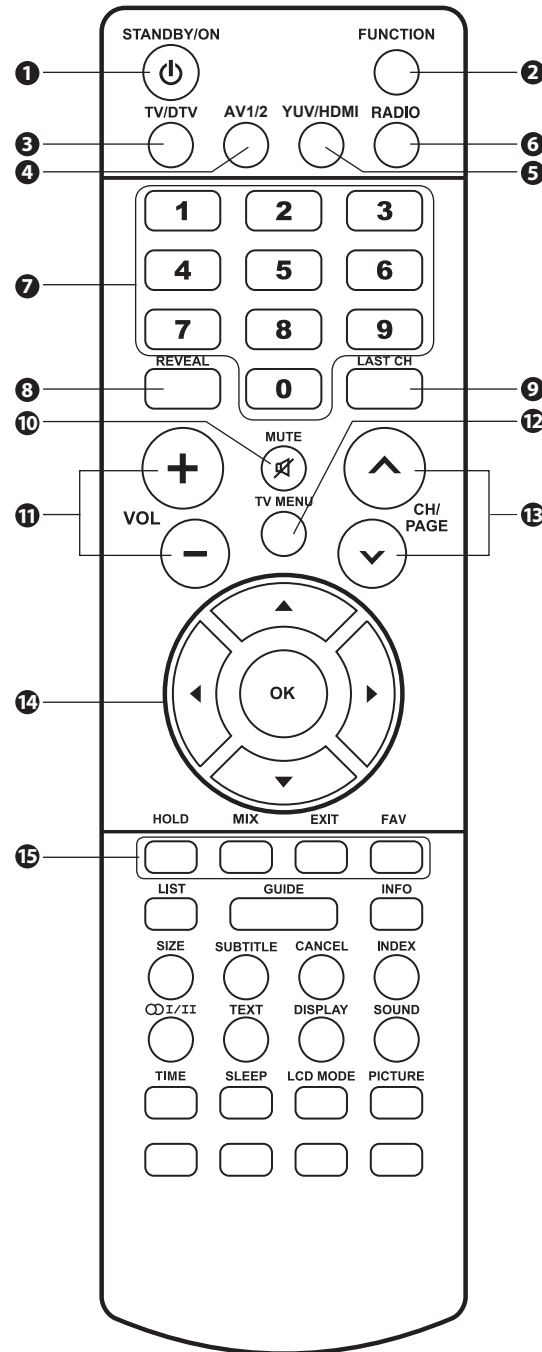



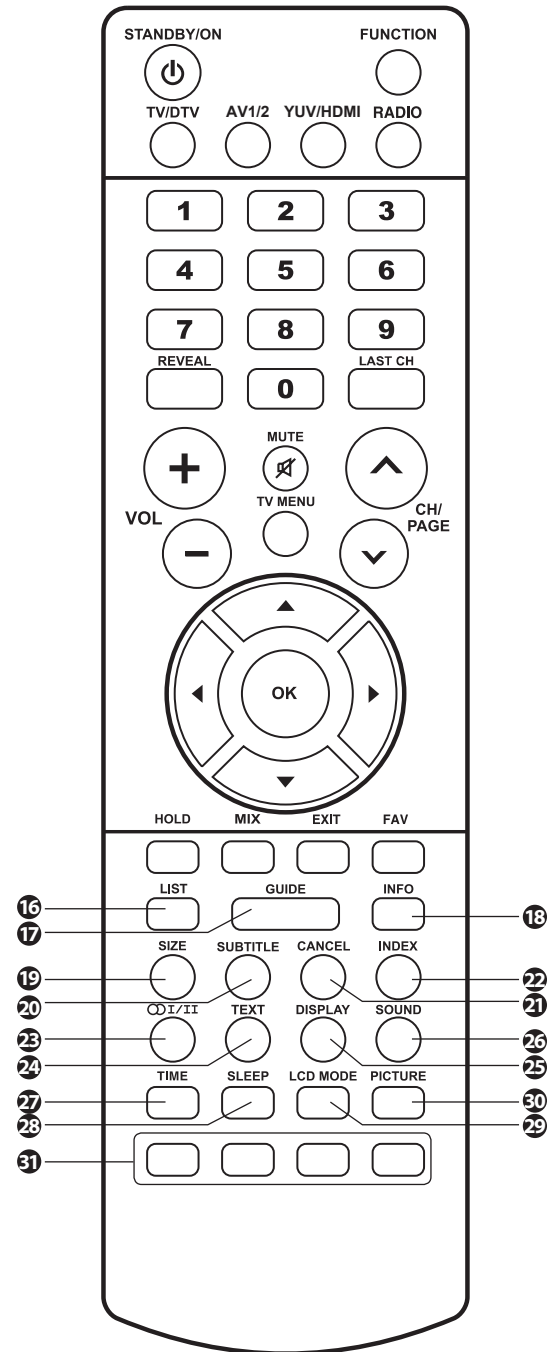

- 16 LIST**
Display a list of channels saved in the TV tuner memory.
- 17 GUIDE**
Display the EPG (Electronic Programme Guide). (DTV mode)
- 18 INFO**
Display channel information. (DTV mode)
- 19 SIZE**
Press to set the letters size of teletext on the screen. (TV mode)
- 20 SUBTITLE**
Select subtitle languages programmed on a DTV broadcasting programmes. (DTV mode)
- 21 CANCEL**
To cancel the teletext mode completely. (TV mode)
- 22 INDEX**
Press to select the page number of the index from Teletext. (TV mode)
- 23 \odot I/II**
Switch between different audio languages: Mono / Stereo or Dual I/Dual II (only applicable when the TV programme has this feature).
- 24 TEXT**
Turn on and off the Teletext function. (TV / DTV mode)
- 25 DISPLAY**
Display the present screen information such as the current channel and the input source.
- 26 SOUND**
Selects sound mode: Standard, Music, Theatre, Voice, Personal.
- 27 TIME**
A short cut to enter and exit the TIME menu.
- 28 SLEEP**
Set the TV sleep timer.
- 29 LCD MODE**
Allows you to watch the screen in various formats: 16:9, 4:3, Auto, Expand, Zoom, LCD Off, etc.
- 30 PICTURE**
Selects picture mode: Standard, Movie, Dynamic, Soft, Personal.
- 31 Coloured buttons**
Access the TELETEXT items or programme edit when using Digital / Freeview TV Channels. (TV / DTV mode)



Making Video and Audio Connections

Not all AV devices have the ability to connect to a TV, please refer to the owner's manual of your AV device for compatibility and connection procedures.

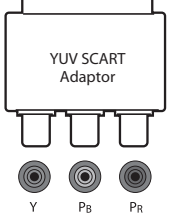

When connecting any external AV device, do not connect the mains cable to the mains socket until all other connections are complete.

Best Video Performance ↑	Signal Type		Separate audio connection required
		HDMI (480i/480p/576i/576p/720p/1080i/1080p*)	No
	 	Component Video (480i/480p/576i/576p/720p/1080i/1080p*)	Yes 
	Composite Video		

* 1080p: Although this TV is compatible with a 1080p input, the screen is not capable of displaying this resolution and consequently the image will be scaled to suit the screen.

Connecting an A/V Device with HDMI Cable

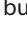
- This TV can accept High-Definition Multimedia Interface (HDMI) supports HDCP (High-Bandwidth Digital Content Protection) Protocol.
- When you connect to the output of an HD ready player (blu-ray disc player, game console, set-top box or computer) switch to the HDMI function and the TV will automatically detect the resolution used by the HDMI source.
- To get the best picture quality, adjust the blu-ray disc player, game console or set-top box output resolution up to 1920 x 1080p.

- Use a HDMI cable to connect the TV's HDMI IN input socket to an external AV device's HDMI output socket.
- Plug the connected devices into the mains socket before plugging your TV into the mains socket.
- Press the  / I button on the top panel of the TV or the  button on the remote control to turn on your TV.
- Press the **FUNCTION** button on the top panel of the TV or on the remote control to display the Source List. Use the   buttons to select **HDMI** mode, and then press the **OK** button. Or you may just press the **YUV/HDMI** button on the remote control to select **HDMI** mode directly.



Although this TV is able to connect to HDMI device, it is possible that some devices may not operate correctly.

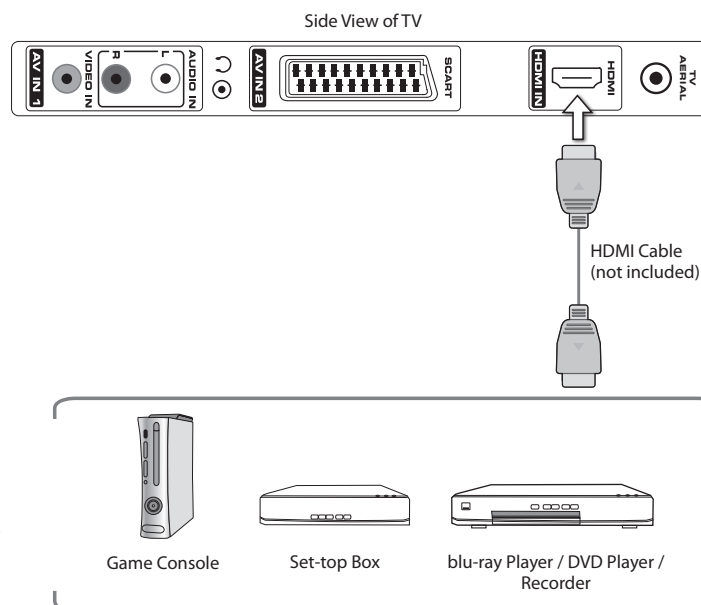

Connecting a High-Definition (HD) Device with YUV SCART Adaptor

1. Use the supplied YUV SCART adaptor and a component cable to connect the TV's SCART input socket to an external AV device's component output socket.
2. Use an audio cable to connect the TV's AUDIO (L/R) input sockets to the external AV device's component audio output sockets. (Audio Left - white and Audio Right = red).

Component port on the TV	Y	Pb	Pr
--------------------------	---	----	----

Video output ports on DVD player	Y	Pb	Pr
	Y	Cb	Cr

3. Plug the connected devices into the mains socket before plugging your TV into the mains socket.
4. Press the **Power / I** button on the top panel of the TV or the **Power** button on the remote control to turn on your TV.
5. Press the **FUNCTION** button on the top panel of the TV or on the remote control to display the Source List. Use the **▲▼** buttons to select **YUV/SCART** mode, and then press the **OK** button. Or you may just press the **YUV/HDMI** button on the remote control to select **YUV/SCART** mode directly.

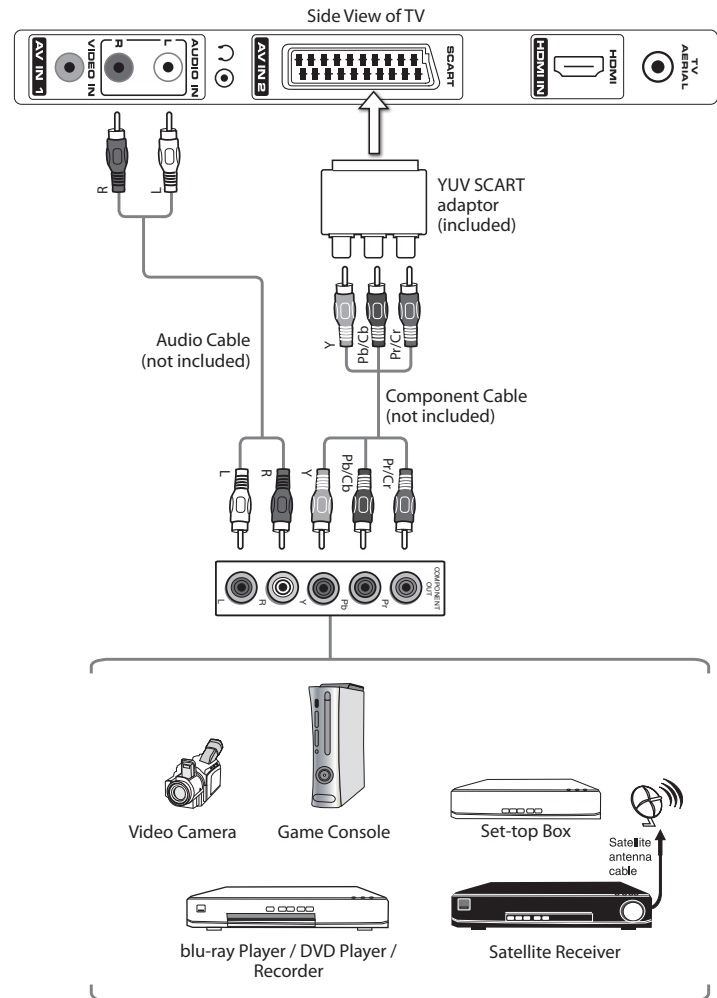

Connecting an A/V Device with SCART Cable

1. Use a SCART cable to connect the TV's SCART input socket to an external AV device's SCART output socket.
2. Plug the connected devices into the mains socket before plugging your TV into the mains socket.
3. Press the **Power / I** button on the top panel of the TV or the **Power** button on the remote control to turn on your TV.
4. The TV will change the input source to **SCART** automatically once the AV device is switched on.

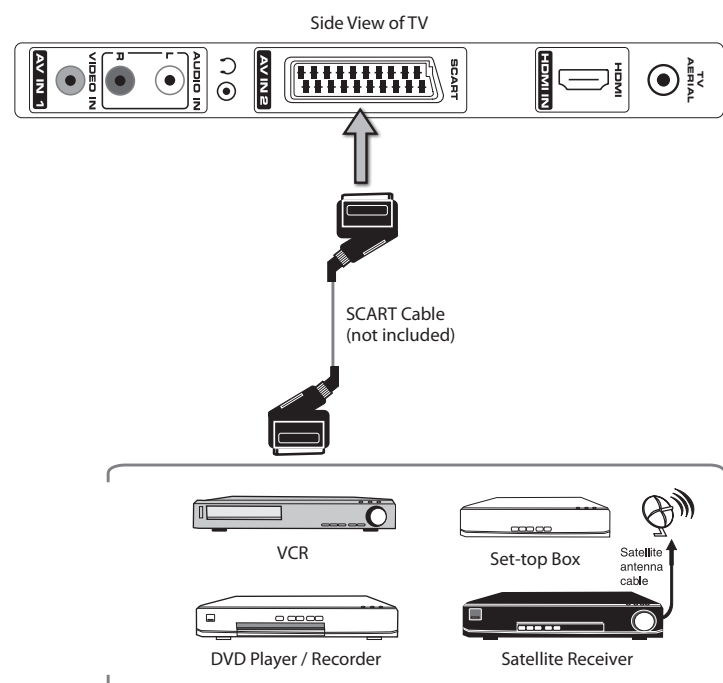

Connecting an A/V Device with Composite Cable

1. Use an AV cable to connect the TV's AUDIO IN / VIDEO IN sockets to an external AV device's composite audio/video sockets. (Video = yellow, Audio Left = white, and Audio Right = red)
2. Plug the connected devices into the mains socket before plugging your TV into the mains socket.
3. Press the **Power / I** button on the top panel of the TV or the **Power** button on the remote control to turn on your TV.
4. Press the **FUNCTION** button on the top panel of the TV or on the remote control to display the Source List. Use the **▲▼** buttons on the remote control to select **AV1** mode, and then press the **OK** button. Or you may just press the **AV1/2** button on the remote control to select **AV1** mode directly.

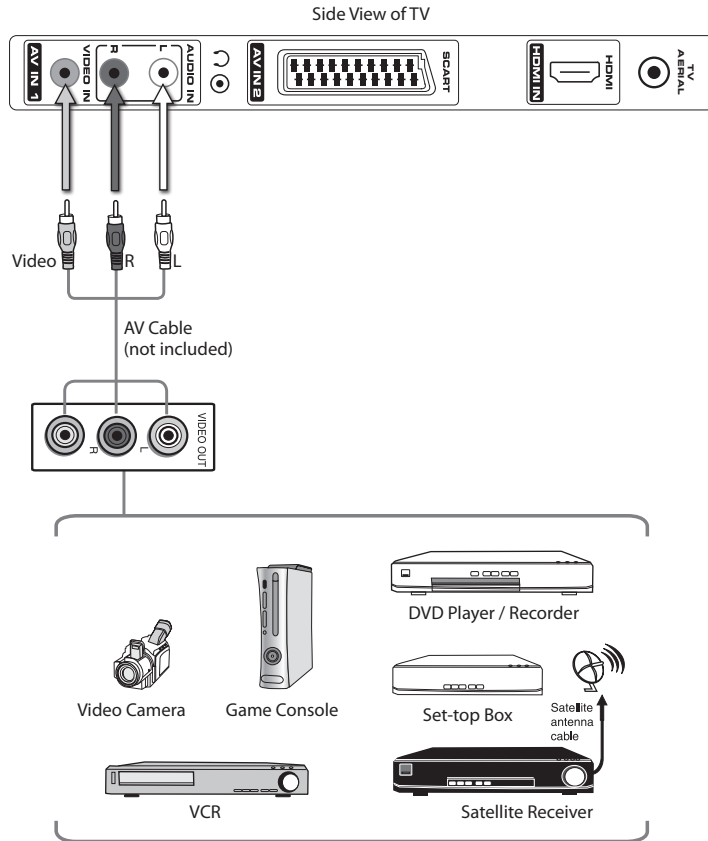

Connecting Earphones

Connect your earphones to the TV's Earphones socket.

Before putting on earphones, turn the volume down then put the earphones on and slowly increase the volume until you reach a comfortable listening level.



Listening to loud sounds for prolonged periods of time may permanently damage your hearing.

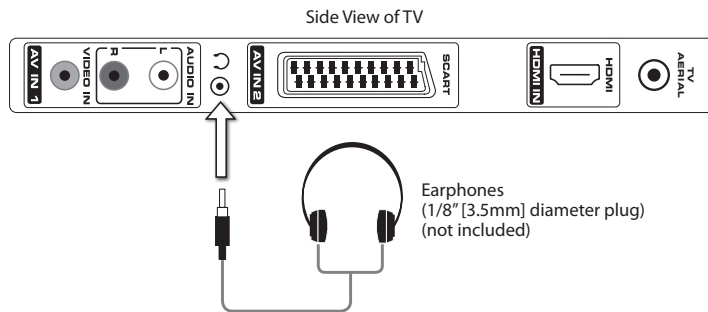

Connecting the Aerial

Connect one end of the RF coaxial cable to the aerial socket on the wall and the other end of the cable to the TV AERIAL socket on the side of your TV.



Do not connect the TV to the mains supply until you have completed all the connections.

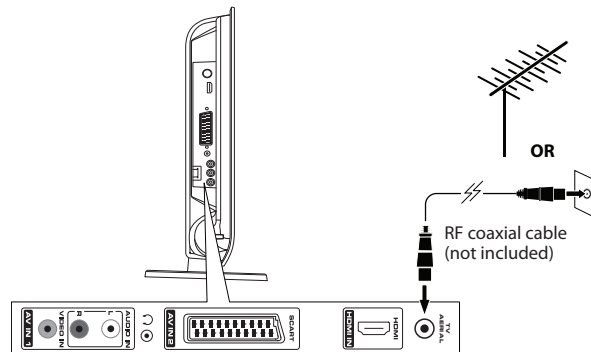

Turning the TV On for the First Time

1. Connect the mains cable to the mains socket after you have completed all the connections. The TV enters standby mode and the power LED on the front panel of the TV will illuminate.
2. In standby mode, press the **⏻ / I** button on the top panel of the TV or the **⏻** button on the remote control to turn the TV on. The power LED will go off.



Always disconnect the TV from the mains socket when not in use for a long period of time.

The **⏻ / I** button on the top panel of the TV or the **⏻** button on the remote control is only used for switching the TV into standby, it does not disconnect the TV from the mains power. To completely disconnect the mains power, please remove the mains plug from the mains socket.

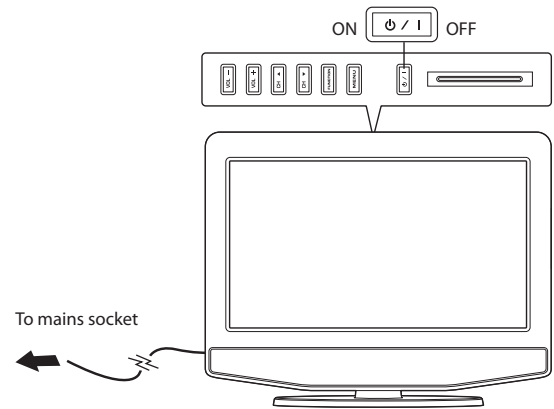

3. The first time you turn the TV on, it will go straight into the **New Installation** menu. (If you have already installed the TV using the Quick Start Guide, please go to the next step "**Selecting the Input Source**" on the next page.)
4. Press the **◀▶** buttons to select your desired language to be displayed on the menu.

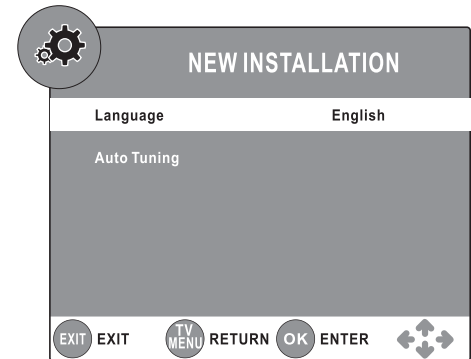

5. Press the **▼** button and then press the **OK** button or the **▶** button to select Auto Tuning.

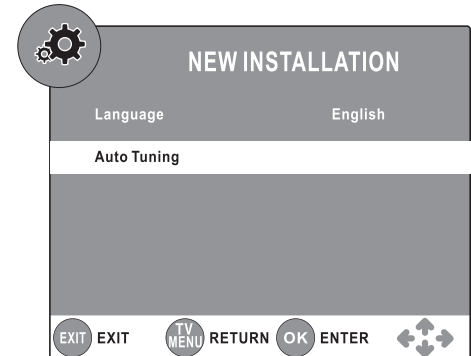

6. A pop-up screen will be displayed, press the **◀▶** buttons to select the Country where you will operate the TV.
7. Press the **▼** button to select **Start** on the screen and then press the **OK** button on the remote control to start the Auto Tuning. Select **Cancel** on the screen or press the **EXIT** button to cancel the New Installation. An installation reminder will appear the next time you turn on the TV.



Selecting the Input Source

1. Press the **FUNCTION** button to display the input source list.
2. Press the **▲▼** buttons to select the input source that you want: DTV, TV, AV1, AV2/SCART, YUV/SCART or HDMI.
3. Press the **OK** button to confirm your selection.

DTV
TV
AV1
AV2/SCART
YUV/SCART
HDMI



Alternative

- Press the **TV/DTV** button to switch the input source between TV and DTV.
- Press the **AV1/2** button to switch the input source among AV1 or AV2/SCART, YUV/SCART or HDMI.
- Press the **YUV/HDMI** button to switch the input source among YUV/SCART or HDMI.
- Press the **RADIO** button to switch to digital radio channels directly (DTV mode only).

Channel Selection



- Press the **CH ▲▼** buttons on the top panel of the TV or the **CH/PAGE ▲ / ▼** buttons repeatedly or **0-9** buttons on the remote control to select the channel.



Alternative

- Press the **LIST** button to display the **Channel List**. Then use the **▲▼** buttons to highlight and select the channel. Press the **OK** button to confirm the setting.
- Press the **FAV** button to view the **Favourite List**. Then use the **▲▼** buttons to highlight and select the favourite channel if you have previously preset your favourite channels. Press the **OK** button to confirm the setting.
- Press the **LAST CH** button to return to the previously viewed channel.
- If a blocked channel is selected, the password screen will be displayed. Press the **0-9** buttons to enter the password, the channel will then be unlocked (refer to page 25 for details on **Block Channel**).

Volume Adjustment

- Press the **VOL +** or **-** button on the top panel of the TV or on the remote control to adjust the volume.
- If you wish to switch the sound off, press the **MUTE**  button, press the **MUTE**  button again or the **VOL +** button to resume audio listening.

Customising the TV Setting (TV, DTV or Radio Mode Only)

Auto Tuning

Use this to automatically find and store all available channels. This is normally recommended if some channels have been added / removed by the broadcaster or you have moved house.

1. Press the **TV MENU** button and then use the ◀▶ buttons to select the **TV SETTING** menu.
2. Press the ▲▼ buttons and then the **OK** button or the ▶ button to select **Auto Tuning**.

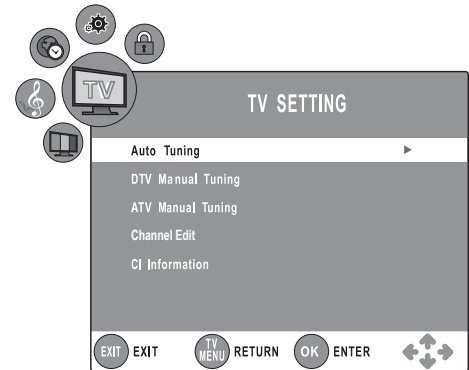

3. Press the ◀▶ buttons to select the Country where you will operate the TV.

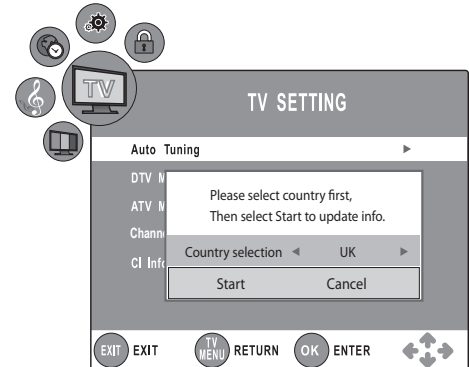

4. Press the ▼ button to select **Start** on the screen then the **OK** button on the remote control to start the Auto Tuning. Auto tuning will commence. The display will show the progress of the tuning and the number of channel found.
5. If you want to skip the ATV tuning, press the **TV MENU** button or the **EXIT** button to interrupt the tuning half way. A pop-up screen will be displayed, press the ◀ button to select **Yes** and then press the **OK** button to confirm.



DTV Manual Tuning

Allows you to make manual fine tuning adjustments if the channel reception is poor under DTV mode.

1. Press the **TV MENU** button and then use the ◀▶ buttons to select the **TV SETTING** menu.
2. Press the ▲▼ buttons and then the **OK** button or the ▶ button to select **DTV Manual Tuning**.

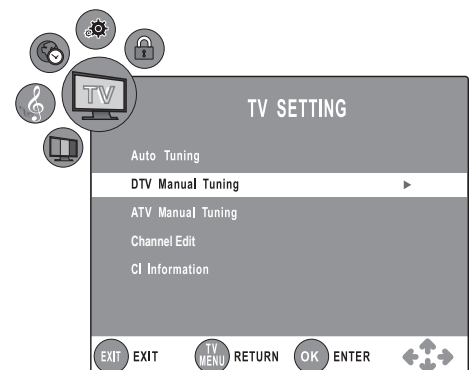

3. The DTV Manual Tuning screen will pop up. Press the ◀▶ buttons to select the UHF channel number you want to tune. Press the **OK** button to commence the search of that channel.
4. Press the **TV MENU** button to return back to the previous menu.
5. Press the **EXIT** button to exit the menu.

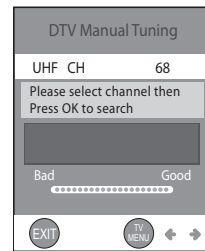

ATV Manual Tuning

Allows you to make manual fine tuning adjustments if the channel reception is poor under analogue TV mode.

1. Press the **TV MENU** button and then use the ◀▶ buttons to select the **TV SETTING** menu.
2. Press the ▲▼ buttons and then the **OK** button or the ▶ button to select **ATV Manual Tuning**.

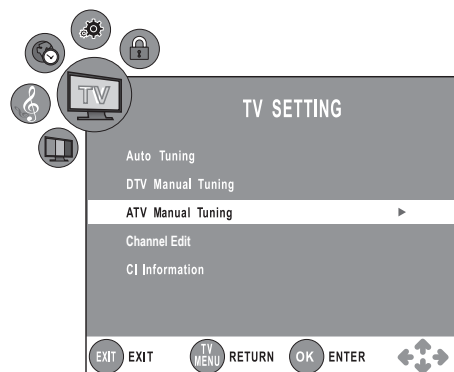

3. The ATV Manual Tuning screen will pop up. Use the ▲▼ buttons to select the following options and the ◀▶ buttons to adjust the setting.

Storage To	Preset the channel number.
System	Select the sound system: I / BG/ DK.
Current CH	Display current channel number.
Search	Press the ◀▶ buttons to start the manual tuning.
Fine-Tune	Press the ◀▶ buttons to make manual fine tuning adjustments.

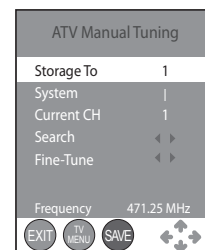

4. After finishing all the manual tuning adjustments, press the **RED** button to save your settings.
5. Press the **TV MENU** button to return back to the previous menu.
6. Press the **EXIT** button to exit the menu.

Channel Edit

Allows you to edit TV programmes in the Channel List.

1. Press the **TV MENU** button and then use the ◀▶ buttons to select the **TV SETTING** menu.
2. Press the ▲▼ buttons and then the **OK** button or the ▶ button to select **Channel Edit**.

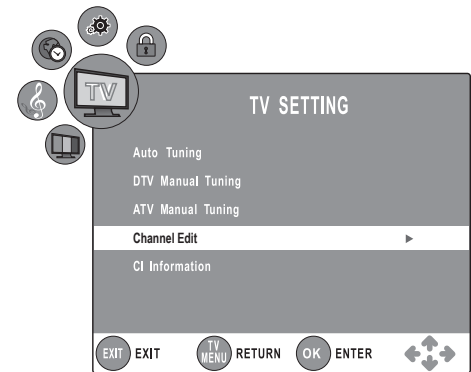

3. A Channel Edit screen will pop up. Press the **CH/PAGE** ▲▼ buttons to skip to previous next page.
4. Press the **RED / GREEN / YELLOW / BLUE** button or the **FAV** button to edit the channel.

a. DELETE

Press the **RED** button on the remote control to delete the selected channel, press the **OK** button to confirm. Press the **TV MENU** button to stop delete.

b. RENAME (ATV mode)

Press the **GREEN** button to rename the selected channel. Use the ▲▼ buttons to select the characters to represent the station name, use the ◀▶ buttons to move to the next character, then press the **TV MENU** button to confirm the new name.

c. MOVE (ATV mode)

Press the **YELLOW** button and use the ▲▼ buttons to move to the selected channel, then press the **TV MENU** button to confirm.

d. SKIP

Press the **BLUE** button to skip or not skip the selected channel. Press the **BLUE** button again to undo it.

e. FAV (Favourite)

Press the **FAV** button to set or cancel the selected channel as one of the favourite programmes.

5. Press the **TV MENU** button to return back to the previous menu.
6. Press the **EXIT** button to exit the menu.



CI (Common Interface) (DTV Mode)

The common interface allows the use of a Common Access Module to enable you to view scrambled (pay to view) services. These services are provided by TopUp TV and others. The Common Access Module and viewing card can be obtained from the service provider.



Do not repeatedly insert or remove the Common Access Module as this may damage the interface and cause a malfunction.

This feature is not available in all countries.

To insert the Common Access Module

1. Before you insert the Common Access Module, ensure that the TV is switched off and the viewing card is inserted in accordance with the Service Provider's instructions.
2. Insert the Common Access Module into the slot. Flip the Common Access Module to another side and try again if you feel resistance.
3. Switch the TV on.

To remove the Common Access Module

1. Before you remove the Common Access Module, ensure that the TV is switched off.
2. Pull the Common Access Module from the slot.
3. Switch the TV on.

To view the module information

1. Press the **TV MENU** button and then use the ◀▶ buttons to select the **TV SETTING** menu.
2. Press the ▲▼ buttons and then the **OK** button or the ▶ button to select **CI Information**.
3. A CI Information Main menu will pop up. Press the ▲▼ buttons to display the Module Information, Smart Card Information, Language, Software Download.
4. Press the **TV MENU** button to return back to the previous menu.
5. Press the **EXIT** button to exit the menu.

Top View of TV

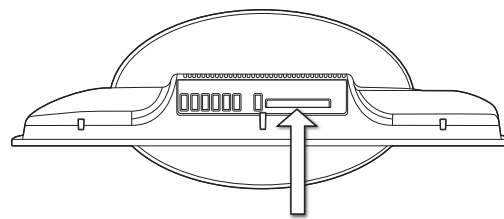

CI (Common Interface) slot

Allows the Common Access Module to be inserted with its label facing back and access the content that has been encrypted.

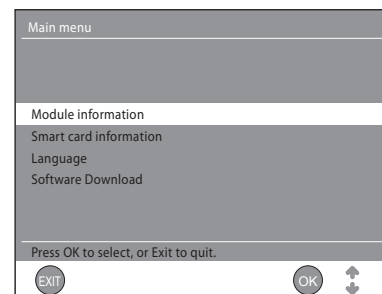
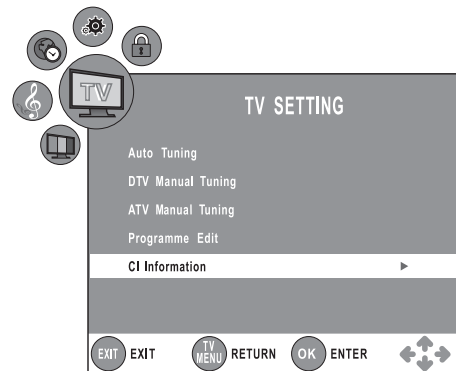

Customising the PICTURE Setting

Allows you to set your preferred picture mode.

1. Press the **TV MENU** button and then use the ◀▶ buttons to select the **PICTURE** menu.

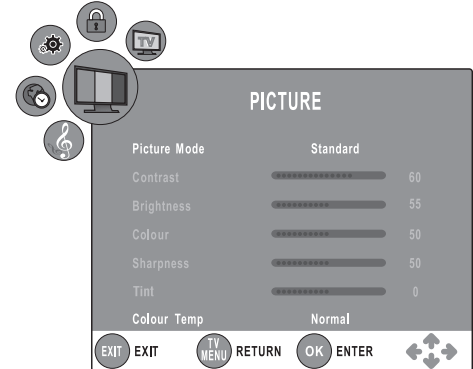

2. Use the ▲▼ buttons to select the following options and the ◀▶ buttons to adjust the setting.

Picture Mode	<p>Cycles among picture mode: Standard / Movie / Dynamic / Soft / Personal.</p> <p> Alternative _____</p> <p>You may press the PICTURE button to select the picture mode directly.</p>
Contrast	Adjusts the difference between light and dark levels in the picture. (for Personal mode)
Brightness	Increase or decrease the amount of white in the picture. (for Personal mode)
Sharpness	Adjusts the level of crispness in the edges between light and dark areas of the picture.
Colour	Controls the colour intensity. (for Personal mode)
Tint (For NTSC format)	Adjusts the balance between red and green levels. (Tint is only available for NTSC signal reception.)
Colour Temp	<p>Adjusts the colour components independently to achieve a warm or cool effect: Normal / Warm / Cold.</p> <ul style="list-style-type: none"> • Normal: Increase natural tint • Warm: Increases red tint • Cold: Increases blue tint

3. Press the **TV MENU** button to return to the previous menu.
4. Press the **EXIT** button to exit the menu.

Customising the SOUND Setting

Allows you to select an audio-enhancement technique.

1. Press the **TV MENU** button and then use the ◀▶ buttons to select the **SOUND** menu.

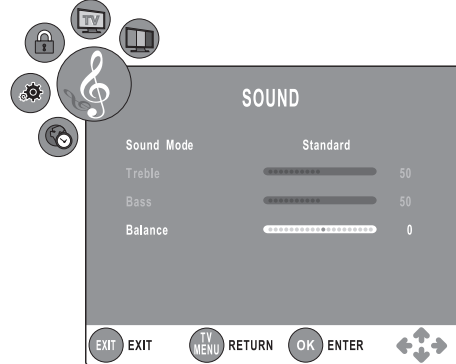

2. Use the ▲▼ buttons to select the following options and the ◀▶ buttons to adjust the setting.



Sound Mode	Allows selection of an audio-enhancement technique from among the following options: Standard / Music / Theatre / Voice / Personal.  Alternative _____ You may press the SOUND button to select the sound mode directly.
Treble	Controls the relative intensity of higher pitched sounds. (For Personal mode)
Bass	Controls the relative intensity of lower-pitched sounds. (For Personal mode)
Balance	Adjusts the relative volume of the speakers in a multiple speaker system.

3. Press the **TV MENU** button to return to the previous menu.
4. Press the **EXIT** button to exit the menu.

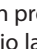
Audio Language for DTV

While watching a DTV programme, you can press the  button to display the Audio Language menu, and select audio language, audio format and sound track.

- Use the ▲▼ buttons to select an audio language or audio format if available, press the ◀▶ buttons to select sound track between L/R (Stereo), L/L (Mono Left) and R/R (Mono Right). Press the **OK** button to confirm.
- Press the **EXIT** button to exit the Audio Language menu.

 For analogue TV, press the  button to select Mono / Stereo or Dual I / Dual II directly.



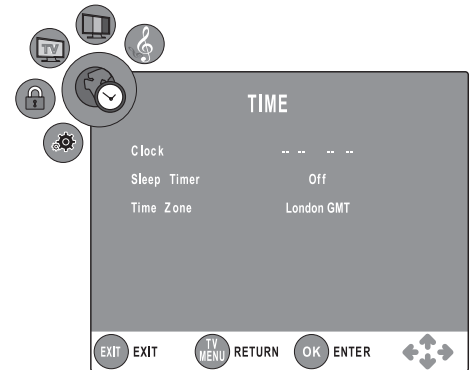

Customising the TIME Setting

1. Press the **TV MENU** button and then use the ◀▶ buttons to select the **TIME** menu.



2. Use the ▲▼ buttons to select the following options and the ◀▶ buttons to adjust the setting.

Clock	<p>The clock is set automatically when receiving a digital signal.</p> <p> Alternative _____ You may press the TIME button to select the display type directly.</p>
Sleep Timer	<p>The sleep timer automatically switches the TV to standby after the preset time has elapsed. The clock will be set automatically when receiving a digital signal. Time must be set before using Sleep Timer function.</p> <p>Press the ◀▶ buttons to select a period of time after which the TV automatically switches to standby mode: Off / 5... / 90 / 120 min. The timer begins to count down from the number of minutes selected.</p> <p> If you turn the TV off after setting the sleep timer, the sleep timer setting will be erased.</p> <p> Alternative _____</p> <ol style="list-style-type: none"> 1. You may press the SLEEP button repeatedly to select the number of minutes: Off / 5... / 90 / 120 min directly. 2. To cancel the sleep time, press the SLEEP button repeatedly until Off appears.
Time Zone	<p>When you select a Time Zone city, the TV time is set by the time offset information based on Time Zone and GMT (Greenwich Mean Time) which is received with the broadcast signal and the time is set automatically by a digital signal.</p>

3. Press the **TV MENU** button to return to the previous menu.
4. Press the **EXIT** button to exit the menu.

Customising the SETUP Setting

1. Press the **TV MENU** button and then use the ◀▶ buttons to select the **SETUP** menu.
2. Use the ▲▼ buttons to select the following options and the ◀▶ buttons to adjust the setting.

Language	Allows you to select your desired on screen menu language.
Audio Language	Allows you to select your desired audio language. (Available for digital channels if multiple audio languages are broadcast.)
Subtitle Language	Allows you to select your desired subtitle language or turn off the subtitle. (Available for digital channels if multiple subtitle languages are broadcast.)
Restore Setting	Restores all settings to factory defaults.

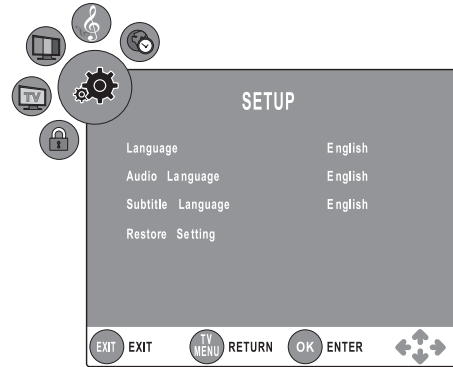

3. Press the **TV MENU** button to return to the previous menu.
4. Press the **EXIT** button to exit the menu.

Video Size (Aspect Ratio)

Allows you to watch the screen in various picture formats: 16:9 / 4:3 / Auto / Expand / Zoom / LCD Off, etc.

Press the **LCD mode** button repeatedly to select the desired format.

16:9

This selection will allow you to adjust the picture horizontally, in linear proportion, to fill the entire screen.



4:3

This selection will allow you to view a picture with an original 4:3 aspect ratio, black bars will appear on both the left and right of the screen.



Auto

When your TV receives a 4:3 or 16:9 signal it will automatically change to the picture format broadcast.

4:3



16:9



Expand

This selection will allow you to view the picture without any alteration, while filling the entire screen with subtitles shown on the bottom of the screen.

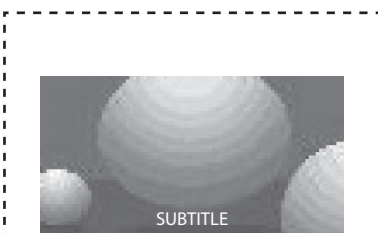

Zoom

This selection will allow you to view the picture without any alteration, while filling the entire screen. However, the top and bottom of the picture will be cropped.

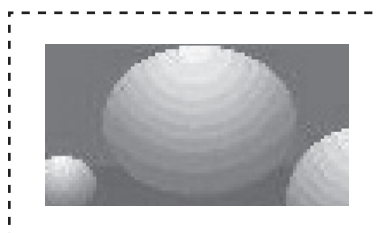

Full (For model L22LDIB10)

This selection will allow you to view the picture in full screen.



Customising the LOCK Setting

To access the LOCK menu, you must enter the password. Enter the default password "0000" for the first time use. To change password, refer to "Change Password" on page 24.

Lock System

Lock System is designed to prevent accidental retuning of the TV / losing channels and prevent children watching unsuitable programmes.

The Lock System must be set to On for this function to operate. If the Lock System is set to On, a valid password must be entered when you access the Auto Tuning / Manual Tuning / Program Edit / New Installation / Block Channel / Parental Guidance.

1. Press the **TV MENU** button and then use the ◀▶ buttons to select the **LOCK** menu.
2. Press the ▼ button and then press the **0-9** buttons to enter the password and enter the **LOCK** menu.
3. Press the ▲▼ buttons to select **Lock System** and then the ◀▶ buttons to select ON.
4. Press the **TV MENU** button to return to the previous menu.
5. Press the **EXIT** button to exit the menu.

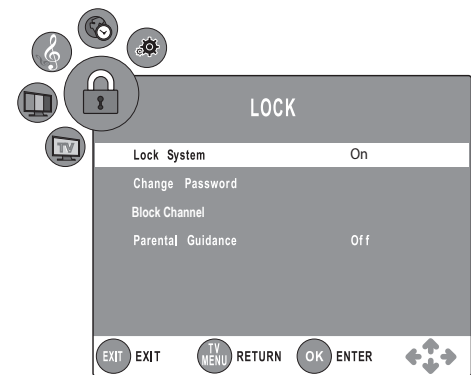

Change Password

1. Press the **TV MENU** button and then use the ◀▶ buttons to select the **LOCK** menu.
2. Press the ▼ button and then press the **0-9** buttons to enter the password and enter the **LOCK** menu.
3. Press the ▲▼ buttons to select **Change Password**, then press the **OK** button or the ▶ button. Enter password to proceed.

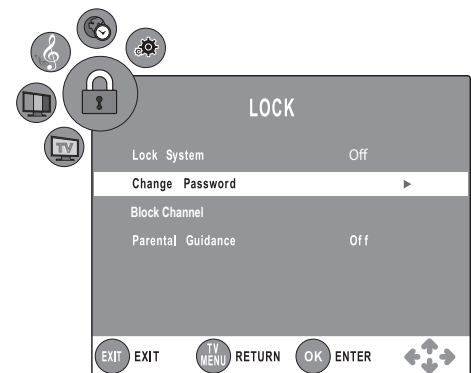

The default password is "0000".
If you change the password, be sure to remember the new password!
If you forget the new password, press the master password "8888" on the remote control.

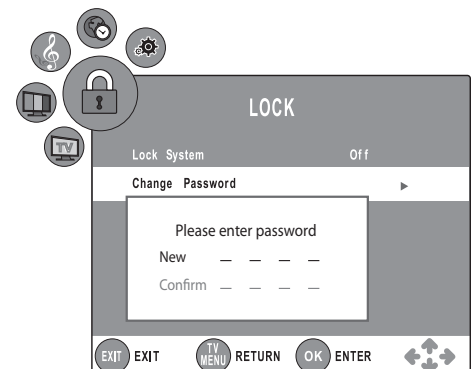

4. Press the **TV MENU** button to return to the previous menu.
5. Press the **EXIT** button to exit the menu.

Block Channel

Block Channel is designed to prevent children watching unsuitable programmes.

The Lock System must be set to On for this function to operate. If the Lock System is set to On, a valid password must be entered.

1. Press the **TV MENU** button and then use the ◀▶ buttons to select the **LOCK** menu.
2. Press the ▼ button and then press the **0-9** buttons to enter the password and enter the **LOCK** menu.
3. Press the ▲▼ buttons to select **Block Channel**, then press the **OK** button or the ▶ button.

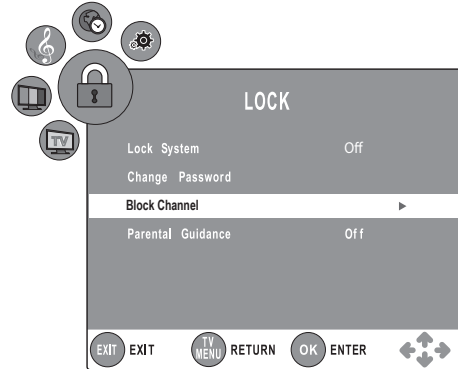

4. A Block Channel screen will pop up. Press the ▲▼ buttons to select a channel. Press the **GREEN** button on the remote control to block or unblock the programme. Press the **GREEN** button again to unblock.
5. Press the **TV MENU** button to return to the previous menu.
6. Press the **EXIT** button to exit the menu.

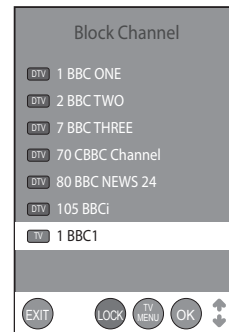

Parental Guidance

This function allows you to set up blocking schemes to block specific channels and ratings. It operates according to information from the broadcasting station, therefore if the signal has incorrect information, this function will not operate. This allows you to set up blocking schemes to block specific channels and ratings.

This TV is programmed to remember which option it was last set to even if you switch the TV off.

When a programme is locked or rated with delayed state, the message "locked programme" is displayed without displaying the password window.

The Lock System must be set to On for this function to operate. If the Lock System is set to On, a valid password must be entered.

1. Press the **TV MENU** button and then use the ◀▶ buttons to select the **LOCK** menu.
2. Press the ▼ button and then press the **0-9** buttons to enter the password and enter the **LOCK** menu.
3. Press the ▲▼ buttons to select **Parental Guidance**, then press the ◀▶ buttons to select different rating: Off, 4, ..., 18.
4. Press the **TV MENU** button to return to the previous menu.
5. Press the **EXIT** button to exit the menu.

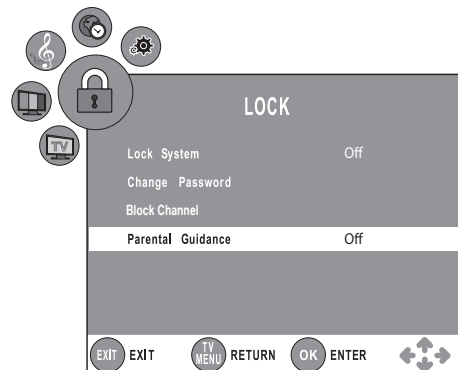

Teletext (TV Mode)

Teletext is a free service broadcast by some TV stations which gives up-to-the-minute information on news, weather, television programmes, share prices and many other topics. Using the Teletext control buttons you can view pages of information that are listed in the teletext index.

To Turn on Teletext Function



Make sure the TV channel you are watching transmits teletext.
"No Teletext" sign will show on the screen if teletext is not available.

In TV mode, press the **TEXT** button to enter Teletext mode. Press the **INDEX** button to display the index page.

Press the **TEXT** button again to exit and the TV will return to the channel you were watching.

To select a page of text

Find the number of the page in the index and enter it using the **0-9** buttons. The number of the page will appear on the top left corner of the screen.

The page counter will search for your page. When it finds it, the page will be displayed.

To move to the next page of text, press the **CH/PAGE**  button.

To move to the previous page, press the **CH/PAGE**  button.

To return to the index page, enter the "100" by using the **0-9** buttons or press the **INDEX** button.

Mix

To view a page of text whilst watching a TV programme press the **MIX** button. The text will be superimposed over the TV programme.

Press the **MIX** button again to return to the text page.

Page search while watching TV

Press the **CANCEL** button while viewing teletext, enter the page number you want by using the **0-9** buttons. The page number will remain on the top left hand corner of the screen.

Double height text

If you have difficulty reading the text on the TV you can double the height of the text.

Press the **SIZE** button. The top half of the page will be displayed in double height text.

Press the **SIZE** button again. The bottom half of the page will be displayed in double height text.

Press the **SIZE** button again to return to the full page.

Page STOP

If the page of text you have selected contains subpages, these subpages will automatically be displayed in order with a delay to allow you to have enough time to read the page.

To stop the move to the next sub page, press the **HOLD** button. " " will appear on the top left corner of the screen.

To continue moving through the sub pages, press the **HOLD** button again.

To Reveal Information

Press the **REVEAL** button to reveal concealed information (quiz answers etc.).

Press the **REVEAL** button again to conceal the information again.

Fasttext

At the bottom of the teletext screen is a row of subject headings in red, green, yellow and blue.

The remote control has a row of colour buttons corresponding to the row of coloured subjects on the screen.

Pressing one of the colour buttons will take you directly to the page corresponding to the subject heading.

Digital Teletext (DTV Mode)

Digital teletext can access special digital teletext services and specific services which broadcast digital teletext. The subtitle will temporarily auto off when digital teletext function is turned on.

Teletext within Digital Service

1. In DTV mode, press the **LIST** button to display the Channel List. Press the **▲▼** buttons to select the teletext channel.
2. Press the **TEXT** button to display the teletext page.
3. Press the **0-9** buttons to select a page number.
4. Follow the instructions on digital teletext and move onto the next step by pressing **OK**, **▲◀▶▼**, **RED**, **GREEN**, **YELLOW**, **BLUE** or **0-9** buttons etc.
5. To change digital teletext service, select a different service by pressing the **0-9** buttons.



EPG (Electronic Programme Guide) (DTV Mode)

This system has an Electronic Programme Guide (EPG) to help you navigate through all the possible viewing options.

The EPG supplies information such as programme listings, start and end times for all available services. In addition, detailed information about the programme is often available in the EPG (the availability and amount of programme information will vary, depending on the particular broadcaster).

This function can be used only when the EPG information is broadcast by broadcasting companies.

The EPG displays the programme details for the next 7 days.

Switch On/Off EPG

1. Press the **GUIDE** button to switch on EPG.
2. Press the **GUIDE** or **EXIT** button again to switch off EPG and return to normal TV viewing.

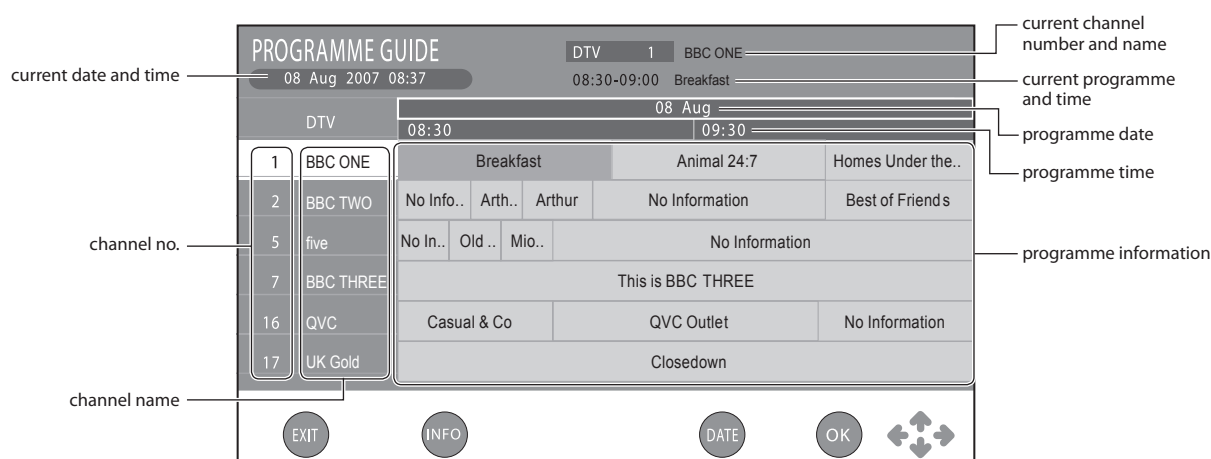

Select a Programme

1. Press the ▲▼ buttons to select the desired channel and the ◀▶ buttons to select the desired programme, and then press the **OK** button to confirm.

Button Functions in a 7 Days Guide

Remote Control Button	Function
YELLOW	Press the ◀▶ buttons to view schedule of the previous / next day, then press the YELLOW button again to confirm.
INFO	To display detailed informations of the selected programme if available.
▲ or ▼	To select a channel.
◀ or ▶	To select a programme.
OK	To confirm and view the selected channel.
GUIDE / EXIT	Switch off EPG.

Maintenance

Careful and regular cleaning can prolong the life of your TV.

 Be sure to disconnect the mains cable from the mains socket before you start any cleaning.

1. Use a soft dry cloth to wipe away the dust from the screen and surfaces.
2. If the surfaces are extremely dirty, clean the TV with a cloth which has been dipped in a weak soapy water. Wring the cloth until it is almost dry, then use it to wipe the TV.
3. Ensure there is no excess water on the screen. Allow any water or dampness to evaporate before switching the TV on.

 Never use alcohol, benzene, paint-thinner, cleaning fluid or other chemicals. Do not use compressed air to remove dust.

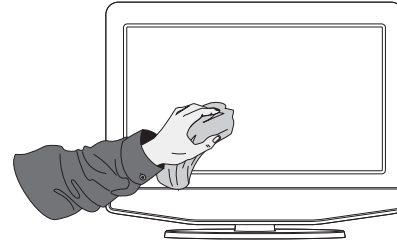

Hints and Tips

If a problem does occur, it may often be due to something very minor. The following table contains various tips.

The TV does not operate properly.	
The remote control does not work	<ul style="list-style-type: none"> • Check to see if there are any objects between the TV and the remote control causing an obstruction. Ensure that you are pointing the remote control directly at the TV. • Ensure that the batteries are installed with correct polarity (+ to +, - to -). • Install new batteries.
Power is suddenly turned off	<ul style="list-style-type: none"> • Check the power of the TV. The mains supply maybe interrupted. • Check if the sleep timer is set. • Check whether the Auto Sleep is activated.
The video function does not work.	
No Picture & No Sound	<ul style="list-style-type: none"> • Check whether the TV is switched on. • Try another channel. The problem may be caused by the broadcaster.
Picture appears slowly after switching on	<ul style="list-style-type: none"> • This is normal, the image is muted during the TV startup process. Please contact your service centre, if the picture has not appeared after five minutes.
No or poor colour or poor picture	<ul style="list-style-type: none"> • Adjust Colour in the menu option. • Try another channel. The problem may be caused by the broadcaster. • Check if the video cables are connected properly.
Horizontal / Vertical bas or picture shaking	<ul style="list-style-type: none"> • Check for local interference such as an electrical appliance or power tool.
Poor reception on some channels	<ul style="list-style-type: none"> • Station or cable channel may be experiencing problems, tune to another station. • Station signal is weak, reposition the aerial for better reception. • Check for sources of possible interference.
Lines or streaks in pictures	<ul style="list-style-type: none"> • Check aerial (Change the position of the aerial.)
No pictures when connecting HDMI	<ul style="list-style-type: none"> • Check if the input source is HDMI.

The audio function does not work.	
Picture OK but no sound	<ul style="list-style-type: none"> • Press the VOL + / - button. • Sound muted? Press the  button. • Try another channel. The problem may be caused by the broadcaster.
No output from one of the speakers	<ul style="list-style-type: none"> • Adjust Balance in the menu option.
Unusual sound from Inside the TV	<ul style="list-style-type: none"> • A change in ambient humidity or temperature may result in an unusual noise when the TV is switched on or off and does not indicate a fault with the TV.
No sound when connecting HDMI	<ul style="list-style-type: none"> • Check if the input source is HDMI.
Audio noise	<ul style="list-style-type: none"> • Keep the RF coaxial cable away from the other connected cables.

Password	
Lost Password	<ul style="list-style-type: none"> • Select the LOCK settings on the settings screen, then enter the following master password "8888". The master password clears your previous password and allows you to enter a new password.

FAQs (Frequently Asked Questions)	
Why have I lost some/all of my channels?	<ul style="list-style-type: none"> • It happens sometimes, if you have a weak signal. Usually it just means you'll need to rescan your digital box or TV. Don't worry, it's easy to do. And once you've done it, you should get all the Freeview channels available to you. If problems persist you may need to get your aerial checked. Talk to your retailer or contact your local aerial installer.
Why do I get 'blocking' on my digital picture?	<ul style="list-style-type: none"> • In most cases, blocking is caused by a reception problem - either the signal is too weak or there is some kind of interference. Talk to your retailer or contact your local aerial installer. • Blocking can also be caused by a digital signal that is too strong. If you are still experiencing blocking and the signal is strong, consult your local aerial installer for advice.
Can I watch Freeview using a portable set-top aerial?	<ul style="list-style-type: none"> • Some, but only a few, homes may be able to use a set top aerial. However, for a much better reception, we strongly recommend that you use a rooftop aerial. • If you do not have access to a rooftop aerial - for example, if you rent a flat and the aerial is the responsibility of your landlord, or if you're using a second TV in the bedroom and don't want the hassle and expense of using extension cables - a set-top aerial may be your only option.
What type of aerial do I need?	<ul style="list-style-type: none"> • If you are installing a new aerial, we recommend a wideband rooftop aerial rather than a loft aerial. Loft aerials generally receive a weaker digital signal and are more likely to get interference from other electrical devices in the home. We suggest you have an aerial survey done before getting an aerial upgrade. • Talk to your retailer or contact your local aerial installer.

Display Modes

The screen resolution has been optimised during production for the display modes listed below.

YPbPr Mode

Resolution	Vertical Frequency (Hz)	Aspect Ratio
576I: 720 x 576	50	16:9, 4:3
576P: 720 x 576		16:9, 4:3
720P: 1280 x 720	50	16:9, 4:3
	60	
1080I: 1920 x 1080	50	16:9, 4:3
	60	
1080P: 1920 x 1080	50	16:9, 4:3
	60	

HDMI Mode

Resolution	Vertical Frequency (Hz)	Aspect Ratio
576I: 720 x 576	50	16:9, 4:3
576P: 720 x 576	50	16:9, 4:3
720P: 1280 x 720	50	16:9, 4:3
	60	
1080I: 1920 x 1080	50	16:9, 4:3
	60	
1080P: 1920 x 1080	50	16:9, 4:3
	60	

Specification

Model	L19LDIB10	L22LDIB10
Panel System	18.5 inch LCD panel	22 inch LCD panel
Display Resolution	1366 pixels (horizontal) x 768 pixels (vertical)	1680 pixels (horizontal) x 1050 pixels (vertical)
Television System	PAL I/BG/DK	PAL I/BG/DK
Brightness	150 cd/m ²	130 cd/m ²
Contrast Ratio	700 : 1	600 : 1
Input / Output		
SCART	1	1
HDMI	1	1
CI	1	1
VIDEO IN (RCA)	1	1
AUDIO IN (RCA) R/L	1	1
RF IN (ATV / DTV)	1	1
Headphone	1	1
Power Source	230V~50Hz	230V~50Hz
Power Consumption	35W, standby < 1W	40W, standby < 1W
Dimension(W x D x H) with base	479 x 170 x 380 mm	554 x 170 x 420 mm
Weight (Net)	3.7 kg	4.6 kg

Features and Specifications are subject to change without notice.

Safety Warnings

- Read all the instructions carefully before using the unit and keep them for future reference.
- Retain the manual. If you pass the unit onto a third party make sure to include this manual.
- Check that the voltage marked on the rating label matches your mains voltage.

Damage

- Please inspect the unit for damage after unpacking.
- Do not continue to operate the unit if you are in any doubt about it working normally, or if it is damaged in any way - switch off, withdraw the mains plug and consult your dealer.

Location of Unit

- The unit must be placed on a flat stable surface and should not be subjected to vibrations.
- Do not place the unit on sloped or unstable surfaces as the unit may fall off or tip over.
- The mains socket must be located near the unit and should be easily accessible.
- This unit is designed for indoor use only.

Temperature

- Avoid extreme degrees of temperature, either hot or cold. Place the unit well away from heat sources such as radiators or gas/electric fires.
- Avoid exposure to direct sunlight and other sources of heat.

Naked Flames

- Never place any type of candle or naked flame on the top of or near the unit.

Moisture

- To reduce the risk of fire, electric shock or product damage, do not expose this unit to rain, moisture, dripping or splashing. No objects filled with liquids, such as vases, should be placed on the unit.
- If you spill any liquid into the unit, it can cause serious damage. Switch it off at the mains immediately. Withdraw the mains plug and consult your dealer.

Ventilation

- To prevent the risk of electric shock or fire hazard due to overheating, ensure that curtains and other materials do not obstruct the ventilation vents.
- Do not install or place this unit in a bookcase, built-in cabinet or in another confined space. Ensure the unit is well ventilated.
- Make sure that there is a gap of at least 10 cm on both sides and a gap of 20 cm at the top.

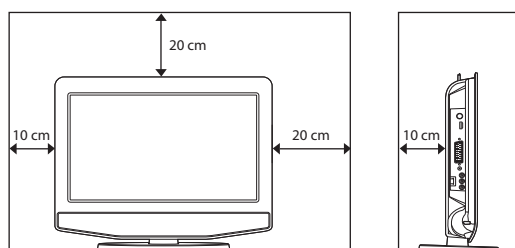

Safety

- Always disconnect the unit from the mains supply before connecting/disconnecting other devices or moving the unit.
- Unplug the unit from the mains socket during a lightning storm.

Mains Cable

- Make sure the unit or unit stand is not resting on top of the mains cable, as the weight of the unit may damage the mains cable and create a safety hazard.
- If the mains cable is damaged it must be replaced by the manufacturer, its service agent, or similarly qualified persons in order to avoid a hazard.

Interference

- Do not place the unit on or near appliances which may cause electromagnetic interference. If you do, it may adversely affect the operating performance of the unit, and cause a distorted picture or sound.

Optimum viewing

- View the unit in moderate light to prevent eye strain. It is recommended to watch the unit from a distance 3-7 times that of the screen height.

LCD screen

- The LCD screen is manufactured using high-precision technology. However, some tiny black points and/or bright points (red, blue or green in colour) may constantly appear on the LCD screen. These points are generated in the manufacturing process and are normal.

Screen Burn

- A characteristic of Plasma and LCD TV Panels is that displaying the same image for a long time may cause a permanent after-image to remain on the screen. This is called screen burn. Most pictures shown on the unit will be constantly moving and fill the screen.
- Examples of images that you need to watch out for are as follows (this is not an all-inclusive list):
 1. **Black Bars:** If black bars appear at the left/right or top/bottom of the screen, it is recommended to change the format so that the picture fills the entire screen.
 2. **TV Channel Logos:** e.g. Shopping channel logos and pricing displays - especially if they are bright and stationary. Moving or low-contrast graphics are less likely to cause ageing of the screen.
 3. **Time Displays**
 4. **Teletext:** Do not view a stationary page for long periods of time.
 5. **TV Menus**
 6. **Pause Mode:** Do not leave the screen in pause mode for long periods of time, e.g. When watching videos.
- To prevent screen burn if viewing any of the above for long periods of time, reduce contrast and brightness when viewing. Once burn-in occurs it will never disappear completely.

Earphones

- Listening to loud sounds for prolonged periods of time may permanently damage your hearing.
- Before putting on earphones, turn the volume down then put the earphones on and slowly increase the volume until you reach a comfortable listening level.

Standby

- The  button on the remote control does not switch off the unit completely. The unit will continue to draw electricity from the mains supply while in standby. In the interests of safety and to avoid unnecessary energy consumption, never leave the unit in standby while unattended for long periods of time, e.g. overnight, while on holiday or while out of the house. Switch it off and disconnect the mains plug from the mains socket.

Batteries

- Batteries used in the remote control for this unit are easily swallowed by young children and this is dangerous.
- Keep loose batteries away from young children and make sure that the battery holder tray is secure in the remote control. Seek medical advice if you believe a cell has been swallowed.
- Please dispose of batteries correctly by following the guidance in this manual.

Supervision

- Children should be supervised to ensure that they do not play with the unit and the remote control.
- Never let anyone especially children push anything into the holes, slots or any other openings in the case - this could result in a fatal electric shock.



The lightning flash with arrowhead symbol, within an equilateral triangle, is intended to alert the user to the presence of uninsulated "dangerous voltage" within the unit's enclosure that may be of sufficient magnitude to constitute a risk of electric shock.



The exclamation point within an equilateral triangle is intended to alert the user to the presence of important operating and maintenance (servicing) instructions in the manual accompanying the unit.

Service

- To reduce the risk of electric shock, do not remove screws. The unit does not contain any user-serviceable parts. Please leave all maintenance work to qualified personnel.
- Do not open any fixed covers as this may expose dangerous voltages.

Maintenance

- Ensure to unplug the unit from the mains socket before cleaning.
- Do not use any type of abrasive pad or abrasive cleaning solutions as these may damage the unit's surface.
- Do not use liquids to clean the unit.





If you require a replacement for any of the items listed below, please quote their corresponding part numbers:

Replacement Part	Part Number
TV Base Stand	509-818125W001 (For Model L19LDIB10) 509-812125W001(For Model L22LDIB10)
Remote control (black)	043-A55652W090
YUV SCART adaptor	138-RGB040W001
Quick Start Guide	810-86J195W010
Instruction Manual	811-86J191W010
Digital TV Switchover Addendum	810-00000SW740



Visit Partmaster.co.uk today for the easiest way to buy electrical spares and accessories. With over 1 million spares and accessories available we can deliver direct to your door the very next day. Visit www.partmaster.co.uk or call 0870 6001 338 (UK customers only) Calls charged at National Rate.



This symbol on the product or in the instructions means that your electrical and electronic equipment should be disposed at the end of its life separately from your household waste. There are separate collection systems for recycling in the EU.

For more information, please contact the local authority or your retailer where you purchased the product.

Notes for battery disposal

The batteries used with this product contain chemicals that are harmful to the environment. To preserve our environment, dispose of used batteries according to your local laws or regulations. Do not dispose of batteries with normal household waste.

For more information, please contact the local authority or your retailer where you purchased the product.

HDMI, the HDMI Logo and High-Definition Multimedia Interface are trademarks or registered trademarks of HDMI Licensing LLC.

The FREEVIEW word and logo are trademarks of DTV services Ltd and are used under licence. ©DTV Services Ltd 2002

The "HD Ready" Logo is a trademark of EICTA.

All trademarks are the property of their respective owners and all rights are acknowledged.

DSG Retail Ltd • Maylands Avenue • Hemel Hempstead •
Herts • HP2 7TG • England

(P.N. 811-86J191W010)